

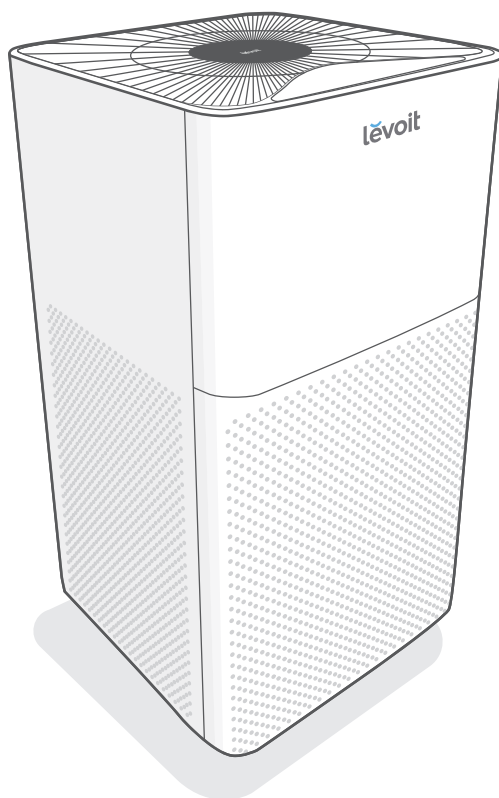

USER MANUAL

Console True HEPA Air Purifier

Model: LV-H135-RWH



Questions or Concerns?

Please contact us at support.eu@levoit.com.

EN**Table of Contents**

Package Contents	4
Specifications	4
Safety Information	5
Getting to Know Your Air Purifier	6
LED Display	7
Getting Started	8
Using Your Air Purifier	9
About the Filter	11
Care & Maintenance	12
Troubleshooting	15
Warranty Information	17
Customer Support	17

FR**Table des matières**

Contenu de l'emballage	32
Caractéristiques techniques	32
Consignes de sécurité	33
Prise en main de votre purificateur d'air	34
Écran LCD	35
Prise en main	36
Utilisation de votre purificateur d'air	37
À propos du filtre	39
Entretien et maintenance	40
Dépannage	43
Informations relatives à la garantie	45
Service client	45

DE**Inhaltsverzeichnis**

Lieferumfang	18
Technische Daten	18
Sicherheitshinweise	19
Ihr Luftreiniger	20
LED-Display	21
Erste Schritte	22
Der Gebrauch Ihres Luftreinigers	23
Informationen zum Filter	25
Pflege und Wartung	26
Problemlösung	29
Garantie	31
Kundendienst	31

ES**Índice**

Contenido de la caja	46
Especificaciones	46
Información de seguridad	47
Componentes del purificador de aire	48
Pantalla LED	49
Primeros pasos	50
Usar el purificador de aire	51
El filtro	53
Cuidado y mantenimiento	54
Solución de problemas	57
Información sobre la garantía	59
Atención al Cliente	59

IT

Indice

Contenuto della confezione	60
Specifiche	60
Informazioni di sicurezza	61
Componenti del purificatore d'aria	62
Display LED	63
Preparazione	64
Uso del purificatore d'aria	65
Il filtro	67
Cura e manutenzione	68
Risoluzione dei problemi	71
Informazioni sulla garanzia	73
Assistenza clienti	73

NL

Inhoudsopgave

Inhoud verpakking	74
Specificaties	74
Veiligheidsinformatie	75
Kennismaking met uw luchtreiniger	76
Led-display	77
Aan de slag	78
Het gebruik van uw luchtreiniger	79
Over de filter	81
Verzorging en onderhoud	82
Probleemoplossing	85
Garantie-informatie	87
Klantenservice	87

Thank you for purchasing the
**CONSOLE TRUE HEPA
AIR PURIFIER BY LEVOIT.**

If you have any questions or concerns, please reach out to us at support.eu@levoit.com. We hope you enjoy your new air purifier!

Find Us Online

Search for [@LevoitUK](#) on social media for tips, special deals, giveaways, inspiration, and more.

Package Contents

- 1 x Air Purifier
- 1 x True HEPA Filter (Pre-Installed)
- 1 x User Manual

Specifications

Power Supply	AC 220–240V, 50Hz
Rated Power	38W
Effective Range	≤ 43 m ² / 463 ft ²
CADR	360 m ³ /h / 212 CFM
Operating Conditions	Temperature: -10°–40°C / 14°–104°F
	Humidity: < 85% RH
Noise Level	≤ 50dB
Standby Power	< 0.8W
Dimensions	53 x 28 x 28 cm / 20.9 x 11.2 x 11.2 in
Weight	6.2 kg / 13.7 lb

SAFETY INFORMATION

To reduce the risk of fire, electric shock, or other injury, follow all instructions and safety guidelines.

General Safety

- **Only** use your air purifier as described in this manual.
- **Do not** use your air purifier outdoors.
- Keep your air purifier away from water, and wet or damp areas. **Never** place in water or other liquids.
- Keep your air purifier away from heat sources.
- **Do not** use where combustible gases or vapours, metallic dust, aerosol (spray) products, or fumes from industrial oil are present.
- Keep 1.5 m / 5 ft away from where oxygen is being administered.
- Supervise children when they are near the air purifier.
- **Do not** place anything into any opening on the air purifier, unless directed by the manual.
- **Do not** sit or place heavy objects on the air purifier.
- Keep the inside of the air purifier dry. To prevent moisture buildup, avoid placing in rooms with major temperature changes.
- **Always** unplug your air purifier before servicing (for example, changing the filter).
- **Do not** use your air purifier if it is damaged or not working correctly, or if the cord or plug is damaged. **Do not** try to repair it yourself. Contact **Customer Support** (see page 17).
- **WARNING: Do not** use this air purifier with solid-state speed controls (such as a dimmer switch).
- Not for commercial use. Household use **only**.

Plug & Cord

- Keep the air purifier near the outlet it is plugged into.
- **Never** place the cord near any heat source.
- **Do not** cover the cord with a rug, carpet, or other covering. **Do not** place the cord under furniture or appliances.
- Keep the cord out of areas where people walk often. Place the cord where it will not be tripped over.

READ AND SAVE THESE INSTRUCTIONS

GETTING TO KNOW YOUR AIR PURIFIER

- A. LED Display
- B. Air Outlet
- C. Housing
- D. Air Intake
- E. Air Quality Sensor
- F. Sensor Cover Sponge
- G. Sensor Cover
- H. Safety Trigger
- I. Filter Cover
- J. Filter
- K. Power Cord

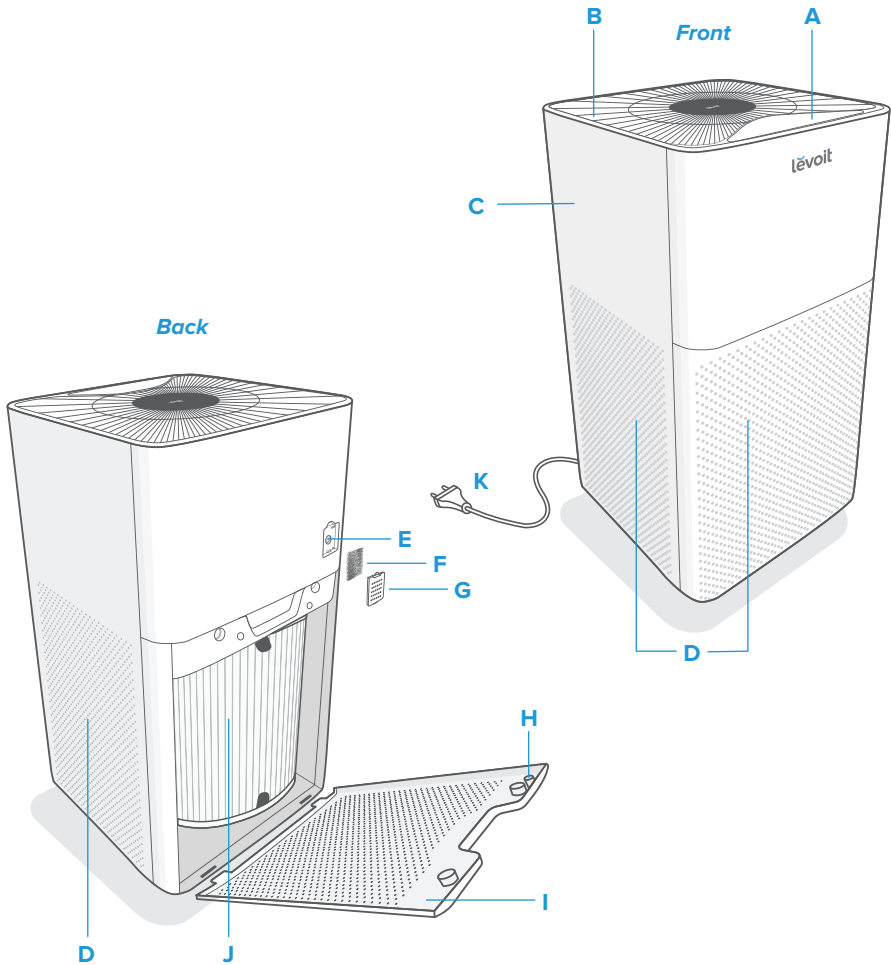

LED DISPLAY

Controls

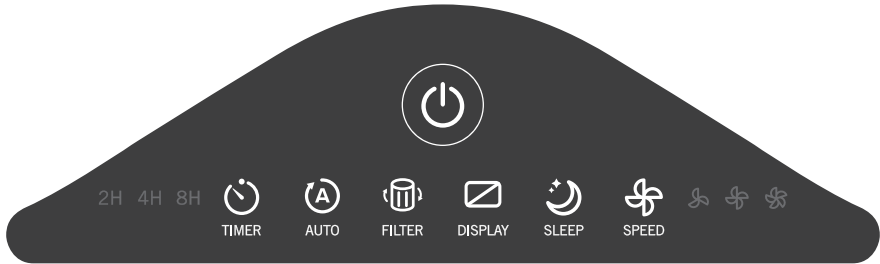

On/Off Button

- Turns the air purifier on/off.



Display Button

- Turns the display off.
- Press any button (except ) to turn the display back on.



Timer Button

- Sets the timer and cycles through timer lengths (see page 9).



Fan Speed Button



- Cycles through fan speeds: low, medium, and high.



Auto Mode Button

- Turns Auto Mode on/off (see page 9).

Fan Speed Chart

Fan Speed Indicator	Fan Speed
	Low
	Medium
	High



Check Filter Indicator

- Lights up red to remind you to check the filter (see page 12).



Sleep Mode Button

- Turns Sleep Mode on/off (see page 9).

GETTING STARTED

1. Pull the handle of the filter cover to open the housing. Remove the filter from the housing. *[Figure 1.1]*

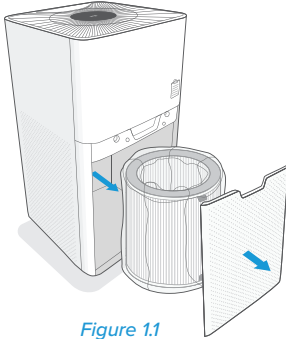

Figure 1.1

3. Replace the filter cover by lining up the cover's feet with the matching slots on the bottom of the housing. *[Figure 1.3]*

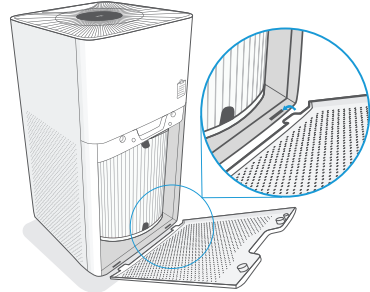

Figure 1.3

2. Take the filter out of its plastic packaging, then reinstall it into the housing. Make sure the pull tabs on the filter are facing out. *[Figure 1.2]*

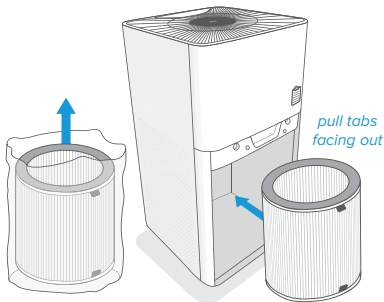

Figure 1.2

4. Push the cover securely closed. *[Figure 1.4]* The air purifier uses a magnetic safety trigger to make sure that the filter cover is closed. If not properly closed, the air purifier will not turn on.

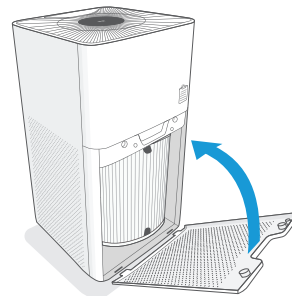





Figure 1.4

Note: If you are not planning to use the air purifier for a long period of time, we recommend keeping the filter clean by leaving it inside its plastic packaging until it is ready to be used.



USING YOUR AIR PURIFIER

General Operation

1. Place the air purifier on a hard, flat surface. Leave 38 cm / 15 in of clearance on all sides of the air purifier.
2. Plug in. Press  to turn on the air purifier. The fan will start automatically.
3. Optionally, press  to change the fan speed. You can also select Auto Mode or Sleep Mode, or select a timer.
 - For best results, or to address a specific air quality issue such as smoke, run the air purifier at high speed for 15–20 minutes before using a lower speed or Auto Mode.
 - To effectively clean air, keep windows and doors closed while the air purifier is operating.
4. Press  to turn off the air purifier.



Auto Mode

Auto Mode adjusts the fan speed automatically based on air quality. For example, if the air quality is bad, the fan will be set to high speed.

- Press  to turn Auto Mode on/off.
- Pressing  or  will also exit Auto Mode.

Sleep Mode

Sleep Mode uses the lowest possible fan speed to operate quietly.

- Press  to turn Sleep Mode on/off.
- Pressing  or  will also exit Sleep Mode.

Timer

- Press  to turn the timer on/off, and to cycle through timer options (2, 4, or 8 hours).
- The air purifier will automatically turn off once the timer is finished.

Note:

- You can change the fan speed at any time while the timer is counting down. The timer will work with any mode.
- Pressing  or unplugging the air purifier will cancel the timer.

Memory Function

The air purifier will remember its programmed settings when turned off, and will resume these settings when turned back on.

Note: The air purifier will not remember timers.

Automatic Shutoff

As a safety feature, the air purifier will automatically turn off if the filter cover is removed.

USING YOUR AIR PURIFIER (CONT.)

Air Quality Indicator

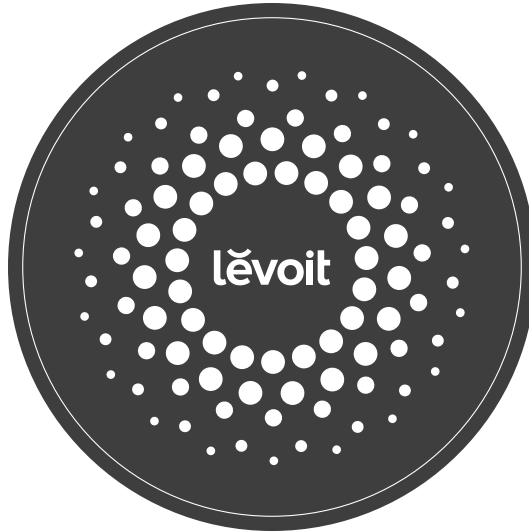

This indicator uses an automatic sensor to display the air quality.

Changing Brightness

Use the palm of your hand to press the air quality indicator to change the brightness.

Note: Touching with just a fingertip may not change the brightness.

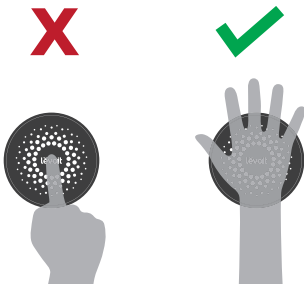

Air Quality Indicator Chart

Colour	Air Quality	Fan Speed
Blue	Very Good	Sleep Mode
Green	Good	Low
Orange	Moderate	Medium
Red	Bad	High

ABOUT THE FILTER

The True HEPA Combination Filter uses a 3-stage filtration system to purify air.

A. Nylon Pre-Filter

- Captures large particles such as dust, lint, fibres, hair, and pet fur.
- Maximises the life of the True HEPA Filter by protecting it.

B. True HEPA Filter

- Removes at least 99.97% of airborne particles 0.3 micrometres (μm) in diameter.
- Filters small particles such as mould spores, tiny dust particles, parts of smoke, and allergens such as pollen, dander, and mites.

C. High-Efficiency Activated Carbon Filter

- Physically adsorbs smoke, odours, and fumes.
- Filters compounds such as formaldehyde, benzene, ammonia, hydrogen sulphide, and volatile organic compounds (VOCs).

CARE & MAINTENANCE

Cleaning the Air Purifier

1. Wipe the outside of the air purifier with a dry cloth. **Do not** clean with water or any other liquid, to avoid risk of electric shock.
2. Clean the outside of the filter with a brush or vacuum hose each month to prevent buildup of hair or dust. **Do not** clean the filter with water or other liquids.

Cleaning the Sensor Cover

If the air quality indicator does not seem to be accurate, clean the sensor cover.

1. Remove the sensor cover. [Figure 2.1]

Note: The sensor cover has a sponge inside to protect the air quality sensor from large particles.

2. Wipe the cover with a dry cloth. Wash the sponge with clean water, then dry.
3. Replace the sponge into the sensor cover, and then replace the sensor cover.

Note: **Do not** throw away the sponge. If the sponge is not in the sensor cover, the air quality sensor may not work correctly.

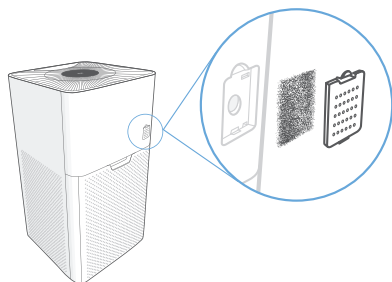









Figure 2.1

Check Filter Indicator

 will light up as a reminder to check the filter. The indicator is automatic. You may not need to replace your filter yet, but you should check it when  turns on.

Resetting the Check Filter Indicator

Reset the Check Filter Indicator when:

-  lights up.
 1. Replace the filter (see page 12).
 2. Turn on the air purifier.
 3. Press and hold  for 3 seconds.
 4. The light will turn off after the filter indicator is successfully reset.
- The filter was changed before  lit up.
 1. Press and hold  for 3 seconds until  lights up.
 2. Press and hold  again for 3 seconds.
 3. The light will turn off after the filter indicator is successfully reset.

CARE & MAINTENANCE (CONT.)

When Should I Replace the Filter?

The filter should be replaced every 6–8 months. You may need to replace your filter earlier or later depending on how often you use your air purifier. Using your air purifier in an environment with relatively high pollution may mean you will need to change the filter more often (even if  is off).

You may need to replace your filter if you notice:

- Increased noise when the air purifier is on
- Decreased airflow
- Unusual odours
- A visibly clogged filter

Note: To maintain the performance of your air purifier, **only** use official Levoit filters. To buy replacement filters, visit Levoit's online store. Go to levoit.com for more information.

Replacing the Filter

1. Unplug the air purifier and remove the filter cover. *[Figure 2.2]*

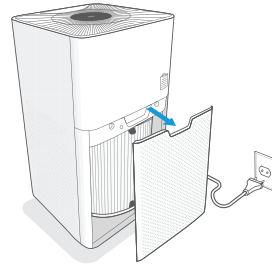

Figure 2.2

2. Remove the old filter. *[Figure 2.3]*

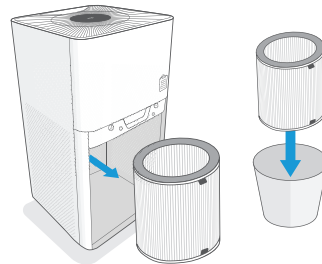

Figure 2.3

3. Clean any dust or dirt from inside the housing. *[Figure 2.4]*

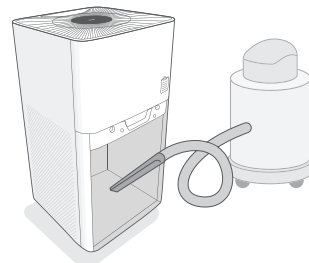

Figure 2.4

Replacing the Filter (cont.)

4. Unwrap the new filter and place it into the housing. Make sure the pull tabs are facing out. *[Figure 2.5]*

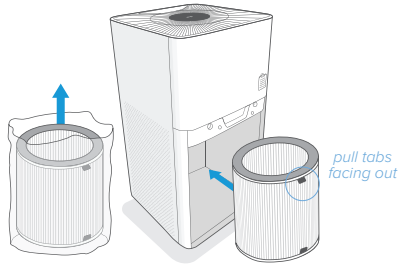

Figure 2.5

5. Replace the filter cover. The air purifier will not power on unless the cover is replaced correctly. *[Figure 2.6]*

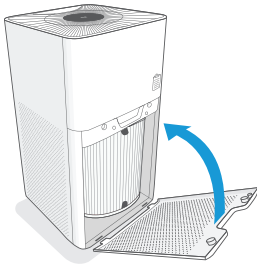





Figure 2.6

6. Plug in and turn on the air purifier.
7. Press and hold  for 3 seconds to reset it.









Storage

If not using the air purifier for an extended period of time, wrap the filter in plastic packaging and store in a dry place to avoid moisture damage.

TROUBLESHOOTING

Problem	Possible Solution
Air purifier will not turn on or respond to button controls.	Plug in the air purifier.
	Check to see if the power cord is damaged. If so, stop using the air purifier and contact Customer Support (see page 17).
	Securely close the filter cover so that the safety switch is activated (see page 8).
	Plug the air purifier into a different outlet.
	Air purifier is malfunctioning. Contact Customer Support (see page 17).
Air purifier makes an unusual noise while the fan is on.	Make sure the filter is properly in place and removed from its plastic packaging (see page 8).
	Replace the filter (see page 13).
	Air purifier may be damaged, or a foreign object may be inside. Stop using the air purifier and contact Customer Support (see page 17). Do not try to repair the air purifier.
Airflow is significantly reduced.	Make sure the filter is removed from its packaging.
	Press  to increase the fan speed.
	Make sure there is clearance of at least 38 cm / 15 in on all sides of the air purifier.
	Replace the filter (see page 13).
Poor air purification quality.	Press  to increase the fan speed.
	Make sure no objects are blocking the top or sides of the air purifier (the inlet or outlet).
	Close doors and windows while running the air purifier.
	Make sure the filter is removed from its plastic packaging and properly in place (see page 8).
	Make sure the room is smaller than 43 m ² / 463 ft ² . The air purifier may not be effective in larger rooms.
	Replace the filter (see page 13).

TROUBLESHOOTING (CONT.)

Problem	Possible Solution
The air purifier is producing an unpleasant odour.	Replace the filter (see page 13).
	Make sure that the air purifier is in a room where the relative humidity is less than 85% RH. Higher humidity levels may cause mildew to grow on the filter.
 is still illuminated after replacing the filter.	Reset  (see page 12).
 has not turned on within 8 months.	 is a reminder for you to check the filter and will light up based on how much the air purifier has been used (see page 12). If you don't use your air purifier often,  will take longer to turn on.
 turned on before 6 months.	 is a reminder for you to check the filter and will light up based on how much the air purifier has been used (see page 12). If you run your air purifier frequently,  will turn on sooner.

If your problem is not listed, please contact [Customer Support](#) (see page 17).

WARRANTY INFORMATION

Terms & Policy

Arovast Corporation warrants all products to be of the highest quality in material, craftsmanship, and service for 2 years, effective from the date of purchase to the end of the warranty period. Warranty lengths may vary between product categories.

If you have any questions or concerns about your new product, please contact our helpful Customer Support Team.

CUSTOMER SUPPORT

Arovast Corporation

1202 N. Miller St., Suite A
Anaheim, CA 92806
USA

Email: support.eu@levoit.com

* Please have your order invoice and order ID ready before contacting Customer Support.

Connect with us @LevoitUK
Verbinden Sie sich mit uns @LevoitGermany
Restez connecté @LevoitFrance
Conecte con nosotros en @LevoitSpain
Seguici su @LevoitItaly
Volg ons via @LevoitLifestyle



levoit
levoit.com

JJ031820CY-M1_0120LV-H135-RWH_eu